



Penn Libraries
UNIVERSITY of PENNSYLVANIA

Center for Global Collections

Penn in the world. The world at Penn.

The Center for Global Collections distinguishes the Penn Libraries — and the University of Pennsylvania — as an **international destination** for students and scholars to engage with the **diversity of cultures and societies around the world**: their histories, perspectives, narratives, and cultural contributions. This world-class Center already boasts expert librarians and preeminent collections, but they require a state-of-the-art space to match. This facility will fill a vital need for a communal venue for global studies programming on campus.

Our renovation will create an **intellectual hub for engagement with the world through dynamic programming — exhibitions, lectures, seminars, and more — that leverages our global studies holdings and expertise**. With your help, we will facilitate the study and dialogue that will shape future generations of global citizens. Will you join us today?



Naming opportunities include:

| | |
|---|---|
| Center for Global Collections Fund the Center's planning and construction and support future infrastructure upgrades | <i>Please Inquire</i> |
| Event Space Locus for dynamic programming, such as lectures, readings, and receptions | <i>Gift Committed</i> |
| Exhibition Space Adaptable venue to showcase objects from our global collections | <i>Gift Committed</i> |
| Director's Office Office for the Center's Director, who shapes strategic vision and oversees team of librarians | \$750,000 |
| Conference Room Communal space for engaging with collections in a collaborative setting | <i>Gift Committed</i> |
| Seminar Rooms (x6) Home base for classes, outfitted with reference materials and cutting-edge technology | \$500,000 each <i>Gift Committed (5/6)</i> |
| Librarian Office (x8) Centrally located offices that make expert staff accessible to students and faculty | \$300,000 each |
| Touchdown Office (x2) Flexible space for library staff and visiting scholars to work with collections | \$250,000 each |
| A central Donor Wall will recognize general support of the project at the \$25,000, \$50,000, and \$100,000 levels. | |
| Interested in supporting the Center's librarians and collections? We can craft custom packages that bundle support for a librarian's work, their office, and relevant collections acquisitions. Please contact Sam Duplessis, Director of Advancement, sd1@upenn.edu for information. | |

5th floor of Van Pelt-Dietrich Library Center
Walnut Street

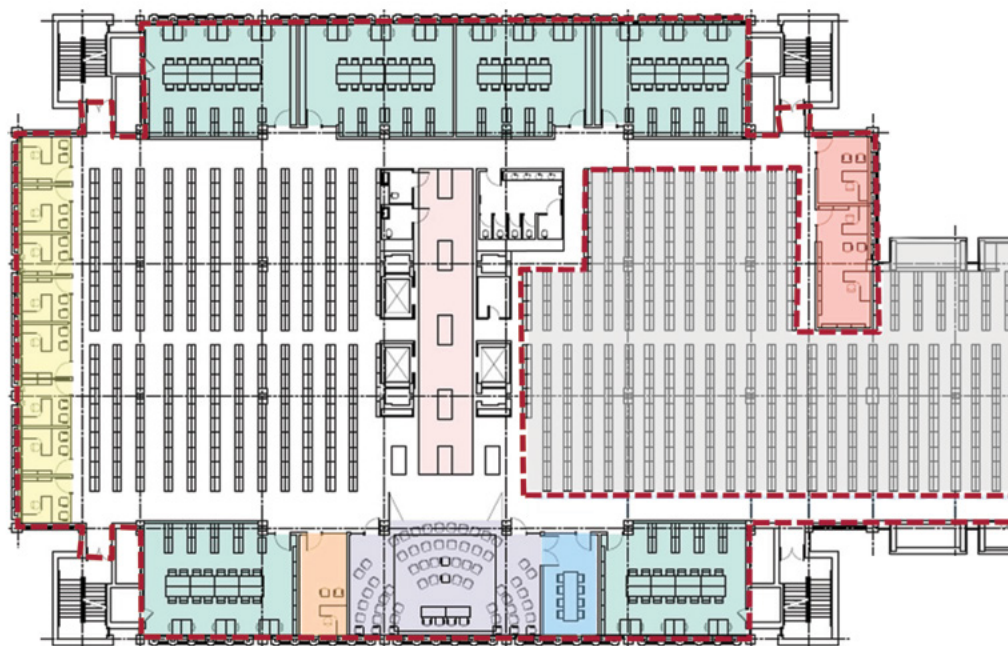

Steven Miller
Conservation
Laboratory

College Green



Penn Libraries

UNIVERSITY OF PENNSYLVANIA

Sam Duplessis
Director of Advancement,
University of Pennsylvania Libraries
sd1@upenn.edu

3420 Walnut St.
Philadelphia, PA 19104
215-898-7555
library.upenn.edu

